

Model 318 Transaxle

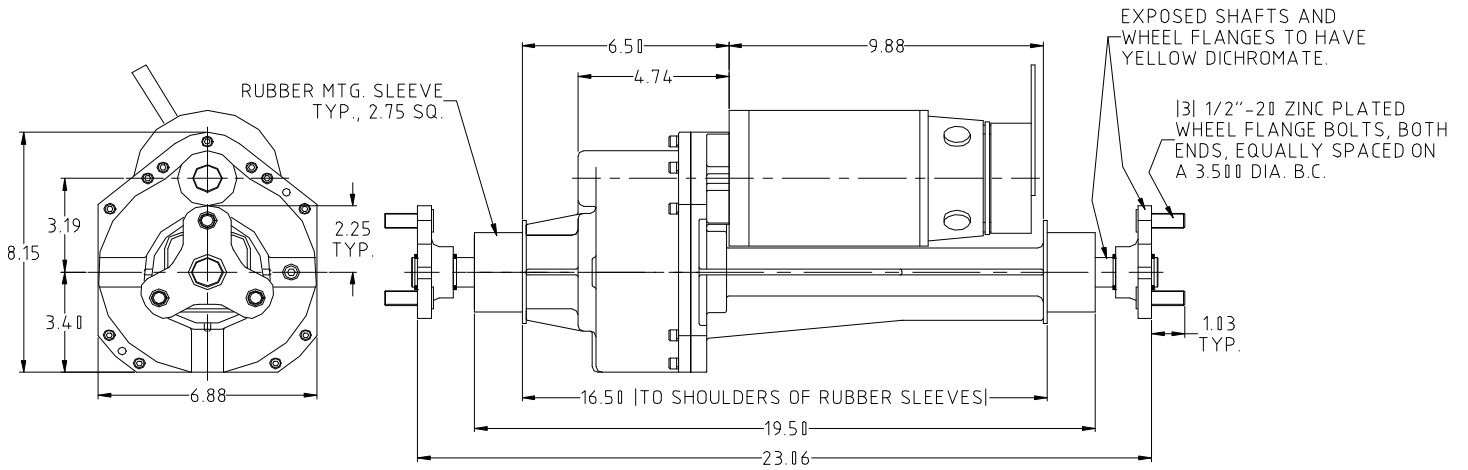

Part No.	Ratio	Output R.P.M.	Motor R.P.M.	Voltage	Hp	Duty	Torque	Motor Dia	Weight	Man. Rel. Brake
318-18-4107D-16	16	75	1200	24 VDC	0.5	Cont.	420 in-lbs.	4-5/8"	45 lbs.	Optional
318-18-4107D-18.8	18.8	64	1200	24 VDC	0.5	Cont.	492 in-lbs.	4-5/8"	45 lbs.	Optional
318-18-3954D-16	16	75	1200	36 VDC	0.5	Cont.	420 in-lbs.	4-5/8"	45 lbs.	Optional
318-18-3954D-18.8	18.8	64	1200	36 VDC	0.5	Cont.	492 in-lbs.	4-5/8"	45 lbs.	Optional
318-18-4155D-16	16	113	1800	36 VDC	0.75	Int.	420 in-lbs.	4-5/8"	45 lbs.	Optional
318-18-4106D-16	16	225	3600	48 VDC	0.7	Int.	196 in-lbs.	4-5/8"	45 lbs.	Optional

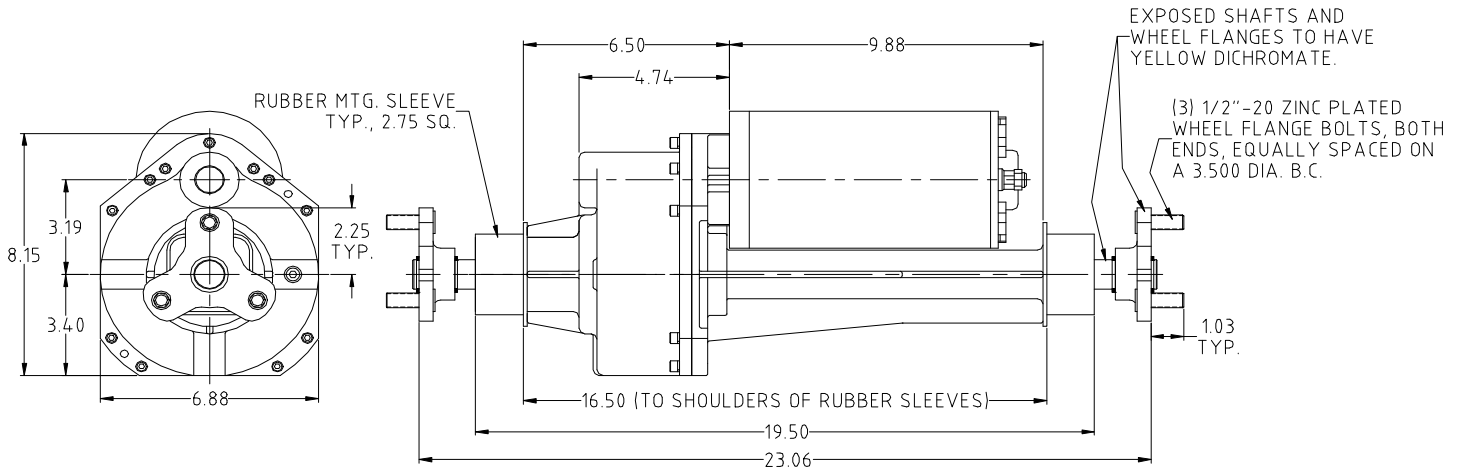

Part No.	Ratio	Output R.P.M.	Motor R.P.M.	Voltage	Hp	Duty	Torque	Motor Dia	Weight	Man. Rel. Brake
318-18-4108D-16	16	200	3200	24 VDC	1.6	Int.	504 in-lbs.	4-5/8"	48 lbs.	N/A
318-18-4109D-16	16	75	1200	36 VDC	1.0	Int.	840 in-lbs.	4-5/8"	48 lbs.	N/A
318-18-4244D-10.3	10.3	282	2900	24 VDC	0.75	Int.	168 in-lbs.	4-5/8"	48 lbs.	Optional

- Custom output shafts and ratios are available upon request.
- Dimensions are for reference only, request certified prints for construction purposes.



A Division of Imperial Electric